

0 1000 mm 5000 10000 20000 mm

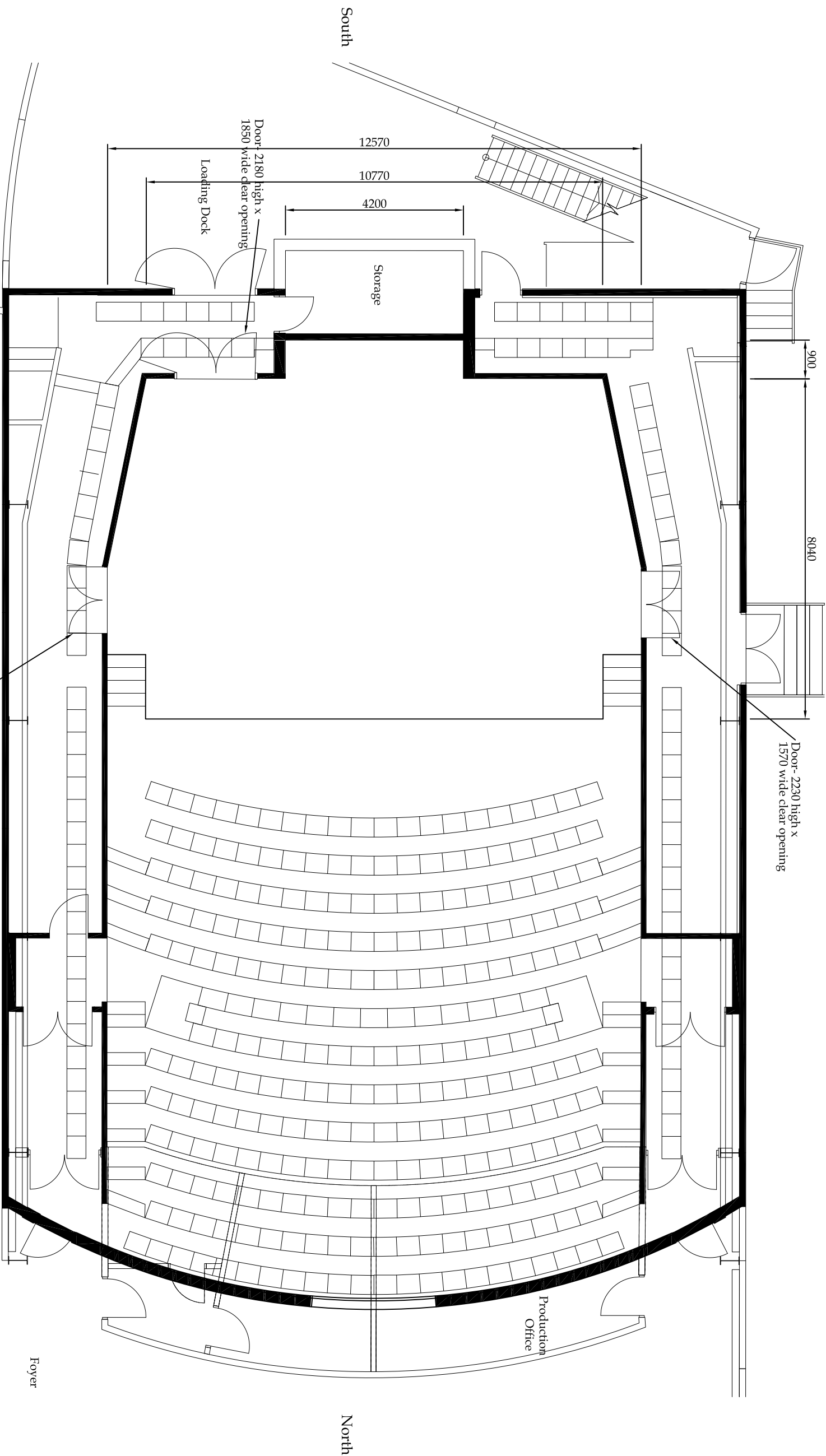

KEY:
 Level 1 _____
 Rooms below seating _____



ADDRESS
 The University of Waikato
 Gate 1 Knighiton Rd
 Hamilton
 Ph 64 7 858 5112
 Fax 64 7 858 5113

Academy of Performing Arts
DR JOHN GALLAGHER CONCERT CHAMBER
 Clear Floor Plan

SCALE	PLAT DATE	SHEET	REVISION
1:100	July 2011	1	B

Drawn by
 PB

This drawing and its contents are the property of The University of Waikato. Any unauthorised employment or reproduction, in full or in part, is forbidden.



GRAPHIC SCALE

acad electrical luo lighting concert chamber ground floor

ORIGINAL SHEET SIZE A3